

SMART CEILING LIGHT User Manual



INTRODUCTION
Dear customer,
Thank you for purchasing our smart ceiling light.
In order to use this product correctly, please read and keep this instruction for future reference.
We are dedicated to the customers to bring a convenient and comfortable experience.

PRODUCT INTRODUCTION
You could directly use the remote control to set the functions.
Adjust the brightness, color temperature and RGB colors.

Smart ceiling light with remote, ideal for bedroom, living room, study room, balcony, home movie theater, party, festival, etc.

2.4G REMOTE CONTROL INSTRUCTION

- Short press: turn on the light
Long press: when the light is powered on in 10 seconds, long press ON until the light flashes once.
Code matching succeeded.
- Short press: turn off the light
Long press: when the light is powered on in 10 seconds, long press OFF until the light flashes once.
Code removal succeeded
- Brightness increases
- Brightness reduction
- Color temperature decreases
- Color temperature increases
- Press it for more than 5 seconds, and the light will enter WiFi pairing mode.
- RGB color static change
- RGB color dynamic scene changes
- The three common scenes of reading, gathering and sleeping are changed circularly
- Night light mode
- Delay to turn off the light for 60s

NOTE
★ Batteries are not included, Battery model: 1.5V AAA No.7 battery.
★ Don't fit for dimmer switch.
★ The remote control distance is 10 meters.
★ Before use, please ensure code matching succeeded.
★ Replace the battery regularly.
★ The brightness of the light can not be adjusted by a wall switch.

ACCESSORIES LIST

- Screw for junction box x2
- Anchor x2
- Screw for anchor x2
- Wire nut x3
- Remote control
- Instruction for installation x1

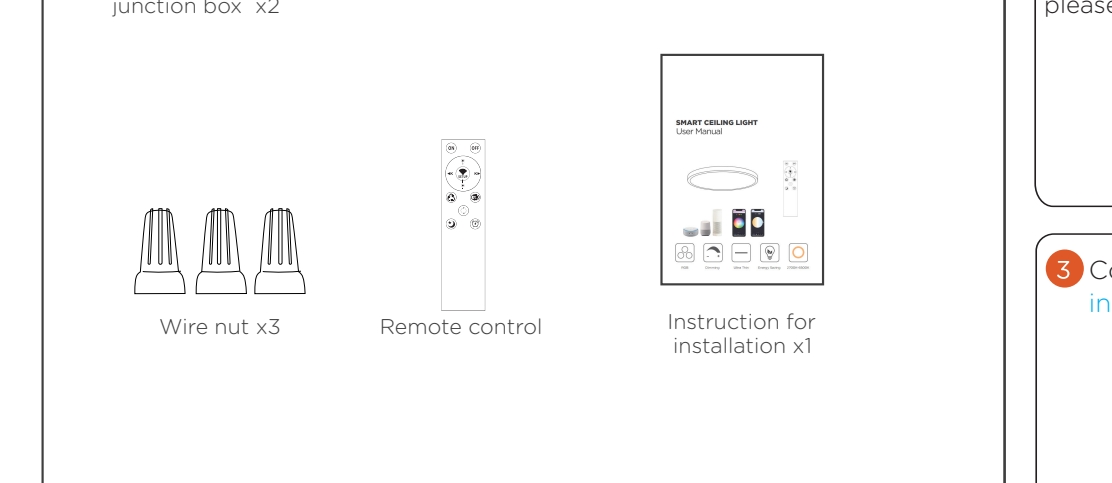

INSTALLATION STEPS
1. After removing the product, unscrew the fix base from the lamp body (counterclockwise rotation).
2. Install the fix ring to the ceiling, here supply two kinds of screws: a. Tapered self-tapping screw b. Flat screw.
(If the above two kinds of screws can't meet your installation requirement, please purchase appropriate screws according to the actual situation)

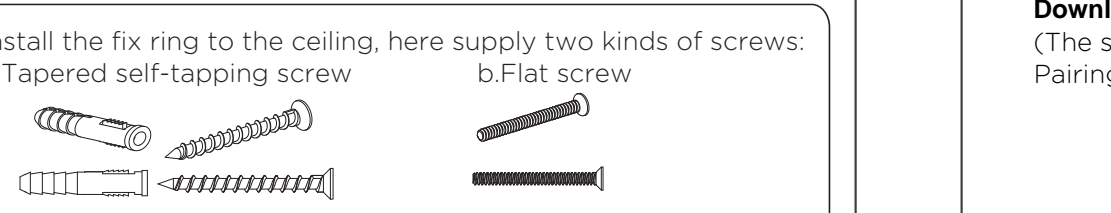

3. Connect the AC wire, L/N. (The lamp body is made of insulating plastic, no need connected to the ground wire)

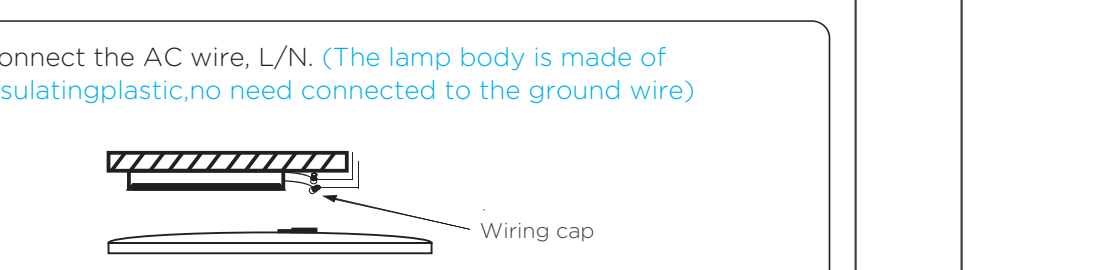

4. Install the lamp body onto the fix base, and then complete the installation!



CONNECT TO 2.4G WIFI
Download "Smart Life" app
(The smart ceiling light can also pair with Tuya Smart app. Pairing process is similar.)

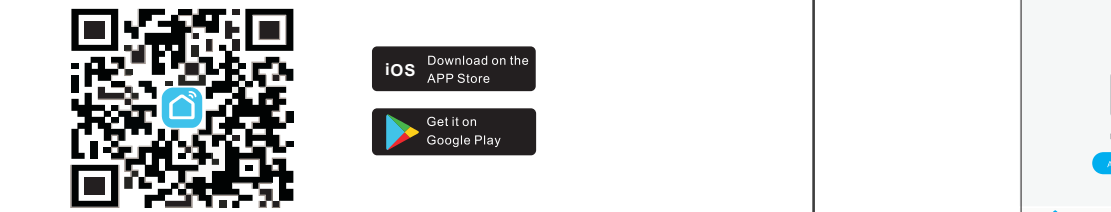

Register and sign in with your mobile phone number or Email address, Connect your phone to WiFi (Only 2.4Ghz)

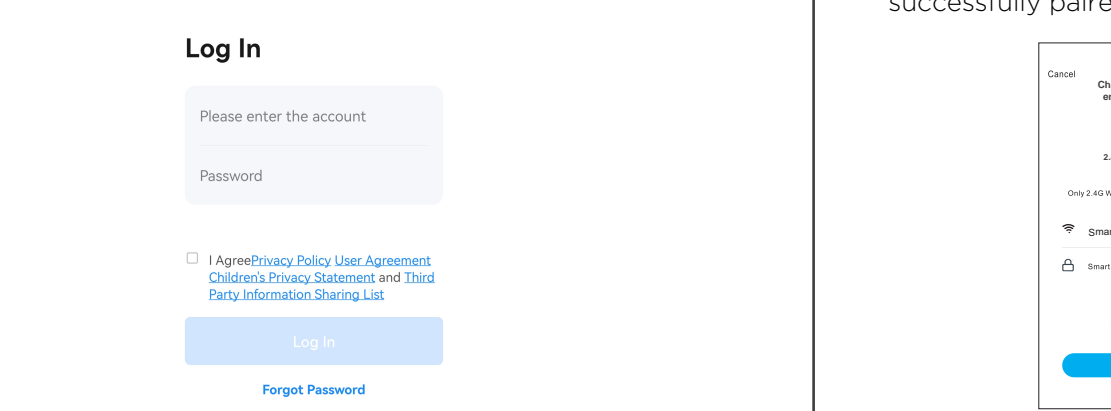

Preparations before pairing to the App
Install the smart ceiling light properly.
Connect your mobile device to 2.4GHz Wi-Fi and enable Bluetooth and Location.

Set up the App
Turn on the power switch, the light will flash quickly and enter into pairing mode automatically. If not, you can reset the light by turning power switch ON-OFF-ON-OFF-ON.
Open the App, the light will be automatically found by the App, then click "Add" to add the smart ceiling light.



Enter 2.4GHz Wi-Fi password and click "Next" button. Once successfully paired, the light will stop flashing.

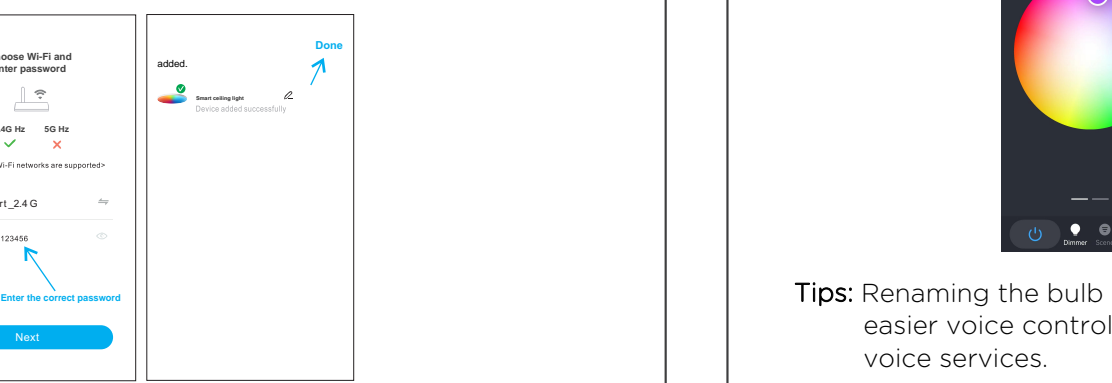

If the App does not find the bulb, click "+" at top right of "Home" page and choose "Add Device". Then click "Lighting" and "Light Source (BLE+Wi-Fi)" to add the bulb manually.

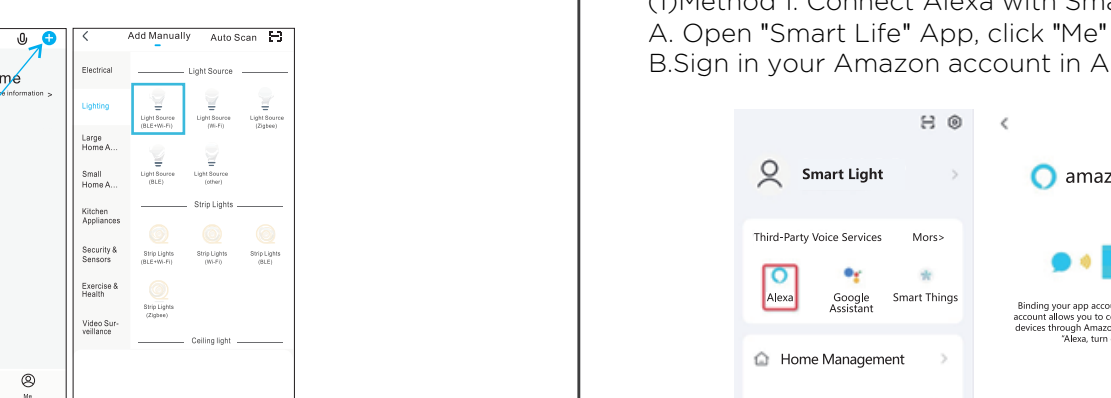

Make sure Bluetooth and Location are enabled during pairing process.
Once the light has connected to the App, you can control the light via the App any time from any place.
The light can be paired to the App one by one, or multiple lights at one time.

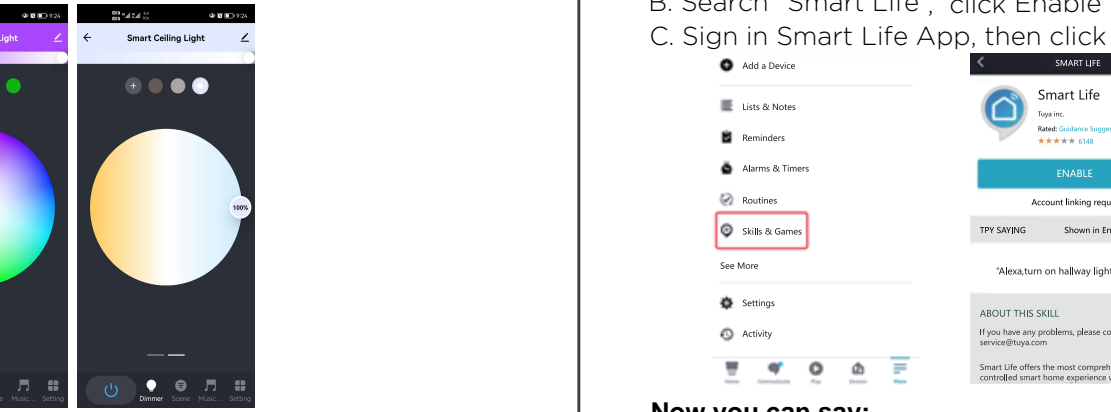

Tips: Renaming the bulb with a simple name is recommended for easier voice control when using Alexa, Google Home or other voice services.

Two methods to connect with Amazon Alexa
Make sure your Alexa device has paired to Alexa App, and the light has paired to Smart Life App.
(1) Method 1: Connect Alexa with Smart Life App
A. Open "Smart Life" App, click "Me" then choose "Alexa".
B. Sign in your Amazon account in Amazon Alexa.

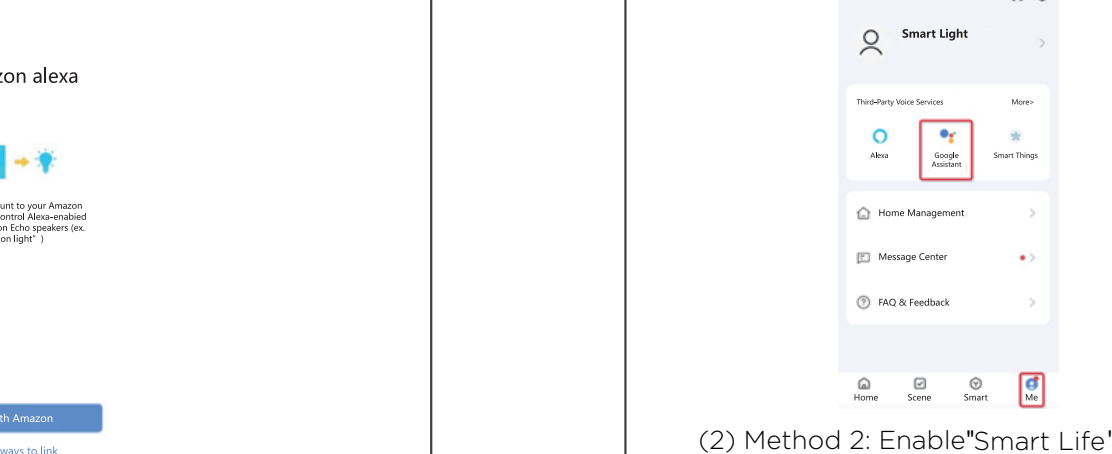

(2) Method 2: Enable "Smart Life" on Alexa App
A. Open Alexa App, click "Skills & Games" on the menu.
B. Search "Smart Life", click "Enable".
C. Sign in Smart Life App, then click "Link Now".



Now you can say:
"Alexa, turn on the bedroom light"
"Alexa, set the living room light to blue"
"Alexa, dim the kitchen light"

Two methods to connect with Google Assistant
Make sure your Google Home device has paired to Google Assistant App, and the light has paired to Smart Life App.
(1) Method 1: Connect Google Assistant with Smart Life App
A. Open "Smart Life" App, click "Me" then choose "Google Assistant".
B. Sign in your Google account in Google Assistant.

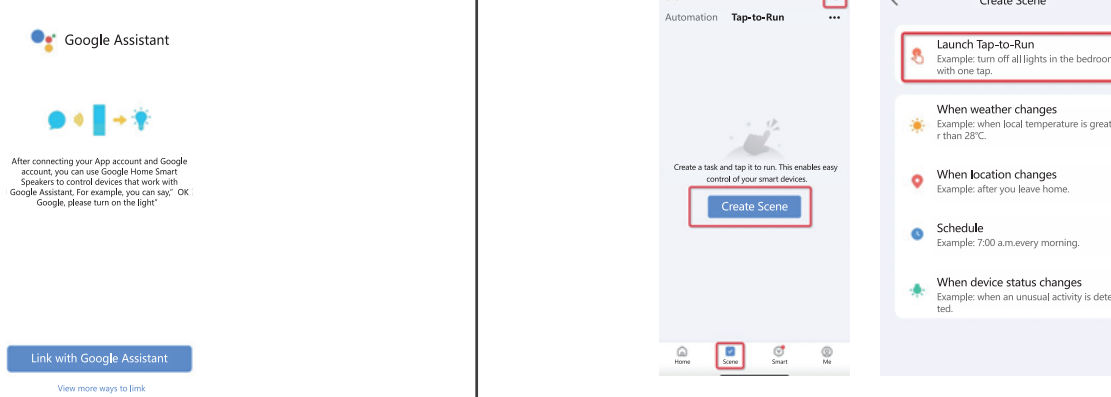

(2) Method 2: Enable "Smart Life" on Google Assistant App
A. Open Google Assistant App, click "Settings" on the home page and select "Works with Google".
B. Search "Smart Life".
C. Sign in Smart Life App, then click "Link Now".

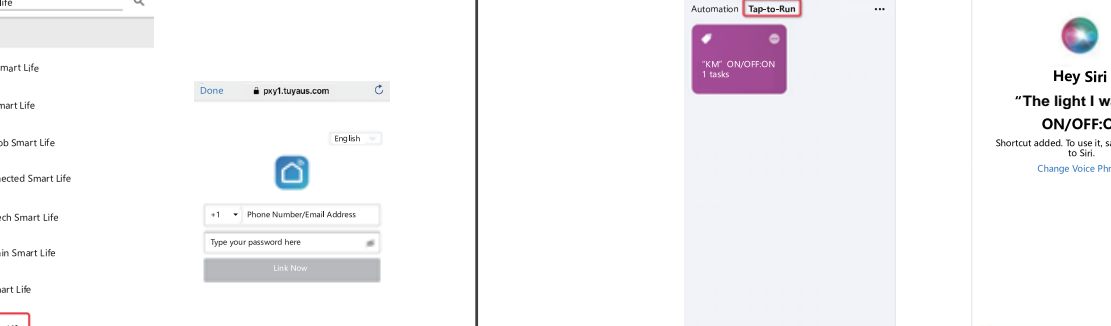

Now you can say:
"Ok Google, turn on the bedroom light"
"Ok Google, set the living room light to blue"
"Ok Google, dim the kitchen light"

Connect with Siri Shortcut (iOS 12.0 above)
The "Tap-to-Run" scenes created on Smart Life App can be voice controlled via Siri shortcut.
A. Enter "Scene" page of Smart Life App and click "Create Scene". Then click "Launch Tap-to-Run".

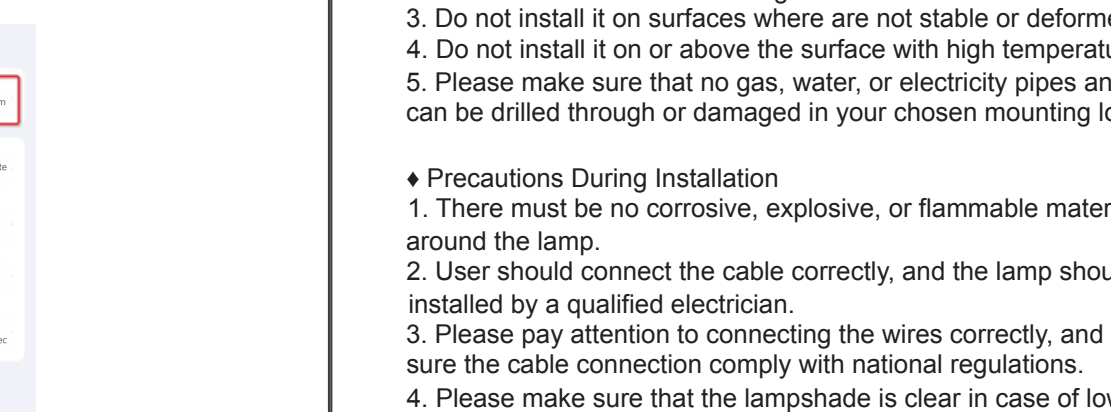

B. Go back to "Tap-to-Run" window on "Scene" page and click "Add to Siri" at the bottom right.
C. Select the scene you want to add to Siri shortcut and set voice phrase.

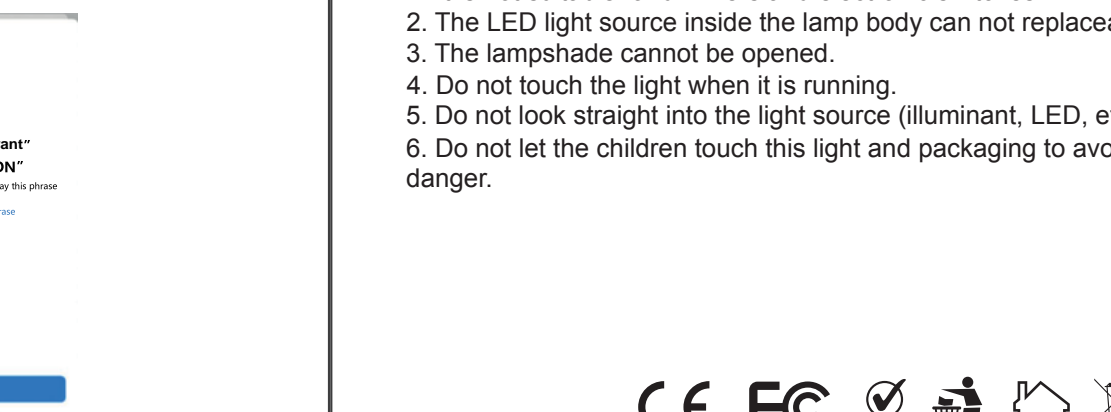

Now you can say:
"Hey, Siri, the light I want"

PRECAUTIONS
◆ Precautions Before Installation
1. Power off before installation.
2. Do not exceed the rated voltage.
3. Do not install it on surfaces where are not stable or deformed.
4. Do not install it on or above the surface with high temperatures.
5. Please make sure that no gas, water, or electricity pipes and wires can be drilled through or damaged in your chosen mounting location.

◆ Precautions During Installation
1. There must be no corrosive, explosive, or flammable materials around the lamp.
2. User should connect the cable correctly, and the lamp should be installed by a qualified electrician.
3. Please pay attention to connecting the wires correctly, and make sure the cable connection comply with national regulations.
4. Please make sure that the lampshade is clear in case of low luminous efficiency.
5. Please make sure that illuminants are securely fixed during the installation.

◆ Precautions About the Product
1. It is not suitable for dimmers and electronic switches.
2. The LED light source inside the lamp body can not replaceable.
3. The lampshade cannot be opened.
4. Do not touch the light when it is running.
5. Do not look straight into the light source (illuminant, LED, etc.).
6. Do not let the children touch this light and packaging to avoid danger.

